

# Short Bolt Hole Collet Support Kit

## Instructions for Use

PLEASE USE THIS INSTRUCTION SHEET IN CONJUNCTION WITH THE RELEVANT TOOL INSTRUCTION MANUAL

*A specialist kit has been developed to enable the Equalizer range of Flange Spreaders (which utilise bolt hole collets) to be operated on flange-joints which are thinner than standard.*

*It provides the required support for the collets as they expand in the flange bolt hole that would normally be provided by a standard thickness of flange*

*Note: Failure to use the collet supports will result in significant damage to the collets*

### GENERAL ARRANGEMENT AND PARTS LIST

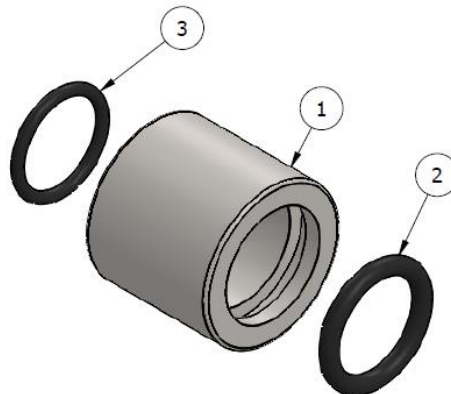

ITEM NO	DESCRIPTION	QTY
1	COLLET SUPPORT	2
2	O-RING (Large Section)	2
3	O-RING (Small Section)	2

### INSTALLATION

- Please refer to the following notes for instruction on how to install the collet supports

1. Place the tool on its side on a work bench or flat surface. Unscrew and remove the drive nut.



2. Pull the collet spring plunger ring out and remove the standard collet head assembly from the tool.



- Slide the drive tube off the collet holder. Select the appropriate collet for the flange joint to be separated and slide it on to the collet holder. Then slide the drive tube back on.



- Slide the collet support kit onto the drive tube. Note orientation of the support from the section view; large O-ring is forward.

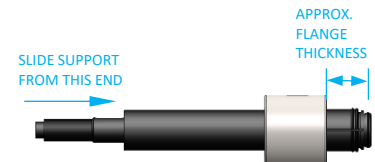

- Re-install collet holder back onto the tool and repeat for the other side

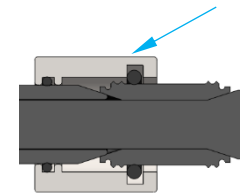

SECTION VIEW

- Slide collet supports so that they are in contact with the flange faces. The tool is now ready to be operated

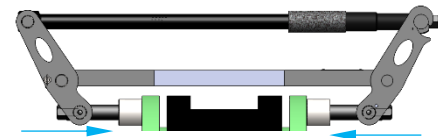

Typical installation examples

## GENERAL OPERATION

- Operate the tool in accordance with the relevant tool instruction manual